

A photograph of a modern building with a swimming pool and landscaping. The building has a white facade with arched windows and a blue tiled roof. The pool is in the foreground, and there are trees and plants around the building. The sky is clear and blue.

Jawhart Al Waseel

In its revamped look

Starting September 1st

Technical Presentation 2026



Jawhart Al Waseel

Jawhart Al Waseel, where luxury meets the extraordinary. An architectural masterpiece in Neo-Classical style, crafted to be the perfect setting for your most cherished occasions. From its grand halls to sweeping green landscapes and serene water features that mirror the spirit of Al Amaria

every detail speaks elegance, exclusivity, and distinction. The ultimate destination for those who seek the exceptional.

Jawhart Al Waseel in Numbers



Riyadh, Kingdom of Saudi Arabia



50,000 Square Meters



+450 Parking Spaces



20 Minutes from Downtown



4.5/5 Visitors Rating

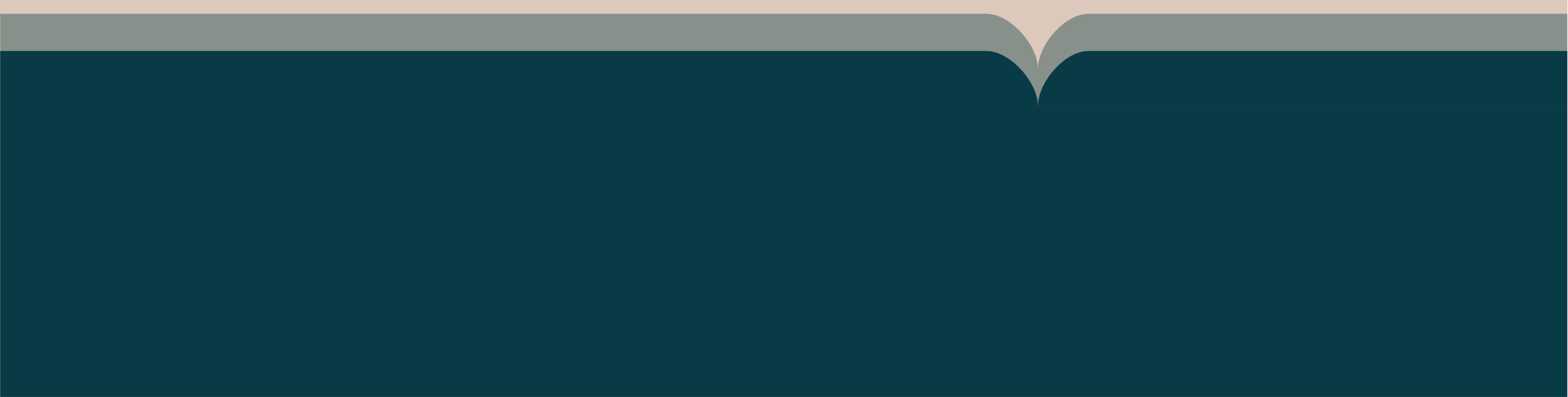
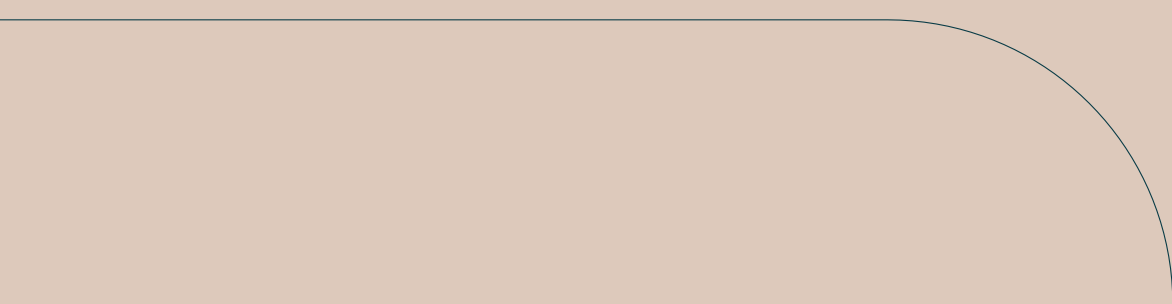
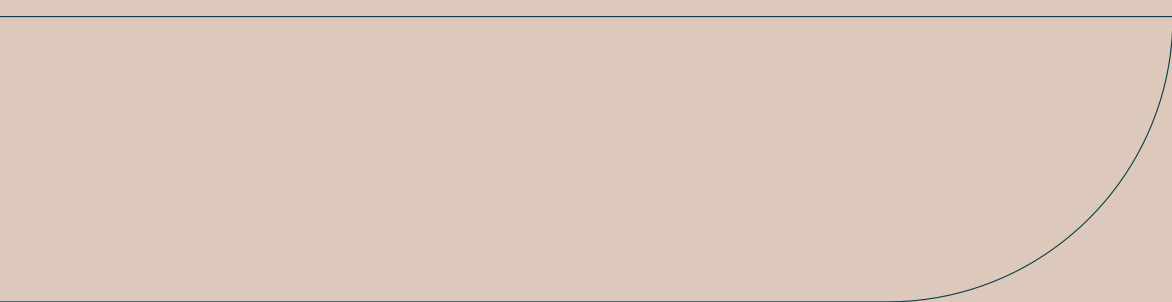



Jawhart Al Waseel



General Perspective



The Hall



The Villa Area



Green Areas



The Courts



Pool Area



Mountain Seating



The Entrance



Jawhart Al Waseel



Main Hall



Main Hall



Dining Hall



Dining Hall



Dining Hall



Bridal Suite



Preparation Room



Restrooms



Technical Specifications

Facilities	Dimensions	Capacity	Additional Features
Main Hall	2100 m ²	1000 +	The ultimate stage for weddings and premium events. Expansive, elegant, and fully flexible with VIP entrances, indoor/outdoor options, dedicated production zones, and ample parking. Every detail, handled. Every moment, unforgettable.
Facilities Villa	450m ²	30+	A fully customizable villa dedicated to your wedding prep featuring a private Majlis and a dedicated makeup room, so every moment before the big day is as luxurious as the event itself.
Green Area	6200m ²	500+	A sprawling outdoor canvas with breathtaking landscaping, setting the perfect backdrop for unforgettable open-air events.
Pool Seating Area	850m ²	200+	Poolside elegance meets outdoor dining, beautifully designed space where every seat feels like a retreat.
Mountain Seating	700m ²	100 +	An elevated escape. Perched high with open views, designed for those who appreciate the art of unwinding in style.

Technical Specifications

The Full Resort

The complete Jawharat Al Waseel estate, comprising both The Mountain Zone and The Oasis Zone operates as a single integrated venue. Total area exceeds 39,000 square meters, combining two grand halls accommodating 1000+ people indoor, a classical mountain view area, two pools surrounded by extensive green areas, separate parking for 500+ cars and dedicated facilities across the full site.

The configuration allows a single event to run across two different settings, or two concurrent functions to be hosted with full separation & privacy. When booked in full, the entire estate, including all halls, outdoor areas, preparation facilities, and parking, is reserved exclusively for one client.



- | | | | | | |
|---|------------------|---|-------------|---|------------------|
| 1 | The Hall | 3 | Green Areas | 5 | Mountain Seating |
| 2 | Facilities Villa | 4 | Pools Area | 6 | Parking Spaces |

Jawharat Al Waseel offers three booking options:

- The Full Venue
- The Mountain Zone
- The Oasis Zone

The Full Hall

A huge hall & dining area spanning 2,100 m², accommodating up to 1,000 guests indoors, operated as one for large-scale events or divided into separate spaces (prioritizing privacy) for simultaneous functions.



1 Main Hall

3 Preparation Room

5 Restrooms

2 Dining Hall

4 Hospitality Prep Room

Full Hall Dimensions:

Height 6.5 M × Length 53.34 M × Width 35.14 M

Technical Specifications

The Mountain Zone:



-  Main Hall
-  Pool Area
-  Mountain Seating
-  Entrance
-  Detached
-  Green Areas
-  Parking Space
-  Facilities (Preparation Room - Restrooms)

The zone exceeds 19,600 square meters. It features a 1,050 square meter hall with a capacity of 500 people, as well as two green areas with a combined area of 800 square meters. Additionally, it includes 6,200 square meters of green spaces and a parking lot that accommodates up to 250 vehicles.

The Mountain Hall

A 1,050 m² indoor hall with main hall & dining area, accommodating up to 500 guests, within the zone alongside its elevated mountain-view seating

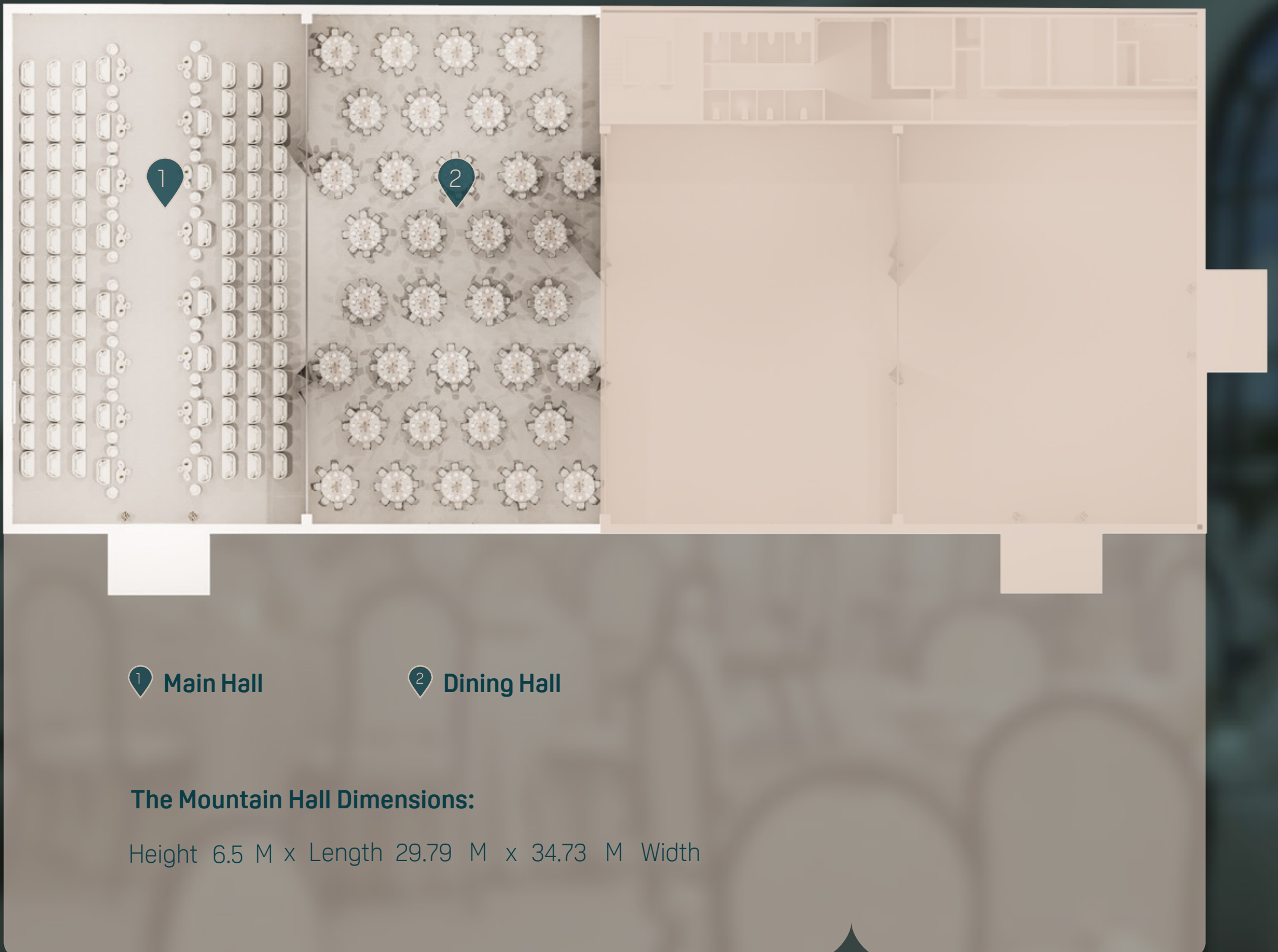

The Mountain Zone:



Entrance



Entrance piece

The Mountain Zone:



Mountain Seating



Mountain Seating

The Mountain Zone:



Main Hall



Dininng Hall

Technical Specifications

The Oasis Zone:



-  Main Hall
-  Pool Area
-  Playgrounds Area
-  Entrance
-  Detached
-  Green Areas Parking
-  Space
-  Facilities (Preparation Room - Restrooms)

An exceptional zone spanning over 19,600 square meters all combined with a parking lot that accommodates 250 vehicles. A space designed to meet your every need. Two courts with a total area of 800 square meters, and stunning green spaces extending over 6,200 square meters, blending luxury and vitality at once. An elegant hall with an area of 1,050 square meters that accommodates up to 500 guests, elevating every experience.

The Oasis Hall

A 1,050 m² indoor hall with main hall & dining area, accommodating up to 500 guests, within the zone alongside its pool views and landscaped

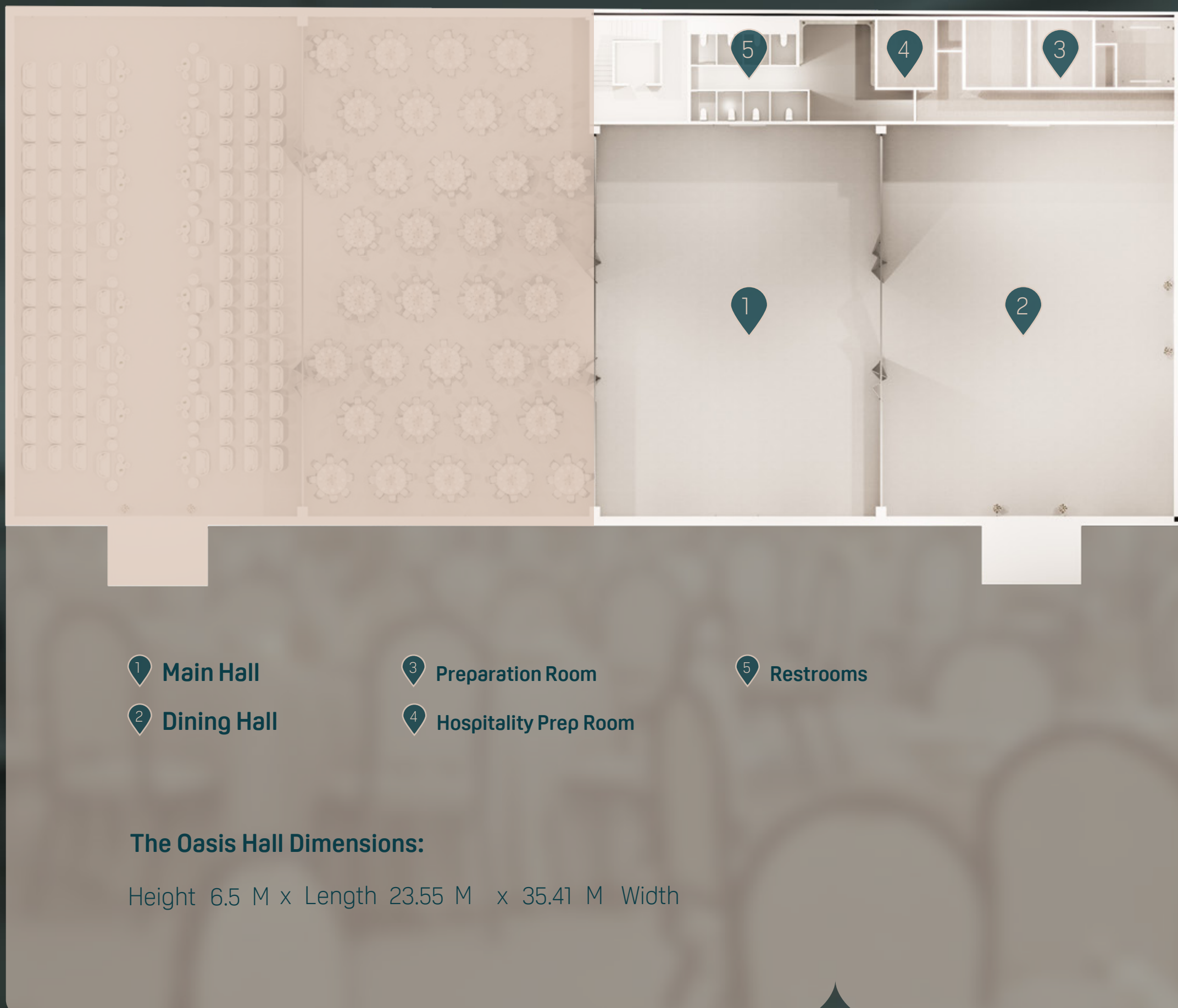

The Oasis Zone:



Green Area



Pool Side

The Oasis Zone:



Padel Courts



Main Hall

The Oasis Zone:



Dining Hall



Private salon

The Oasis Zone:



Private salon



Bridal Suite

Jawharat Al Waseel Resort ✨

Before



After

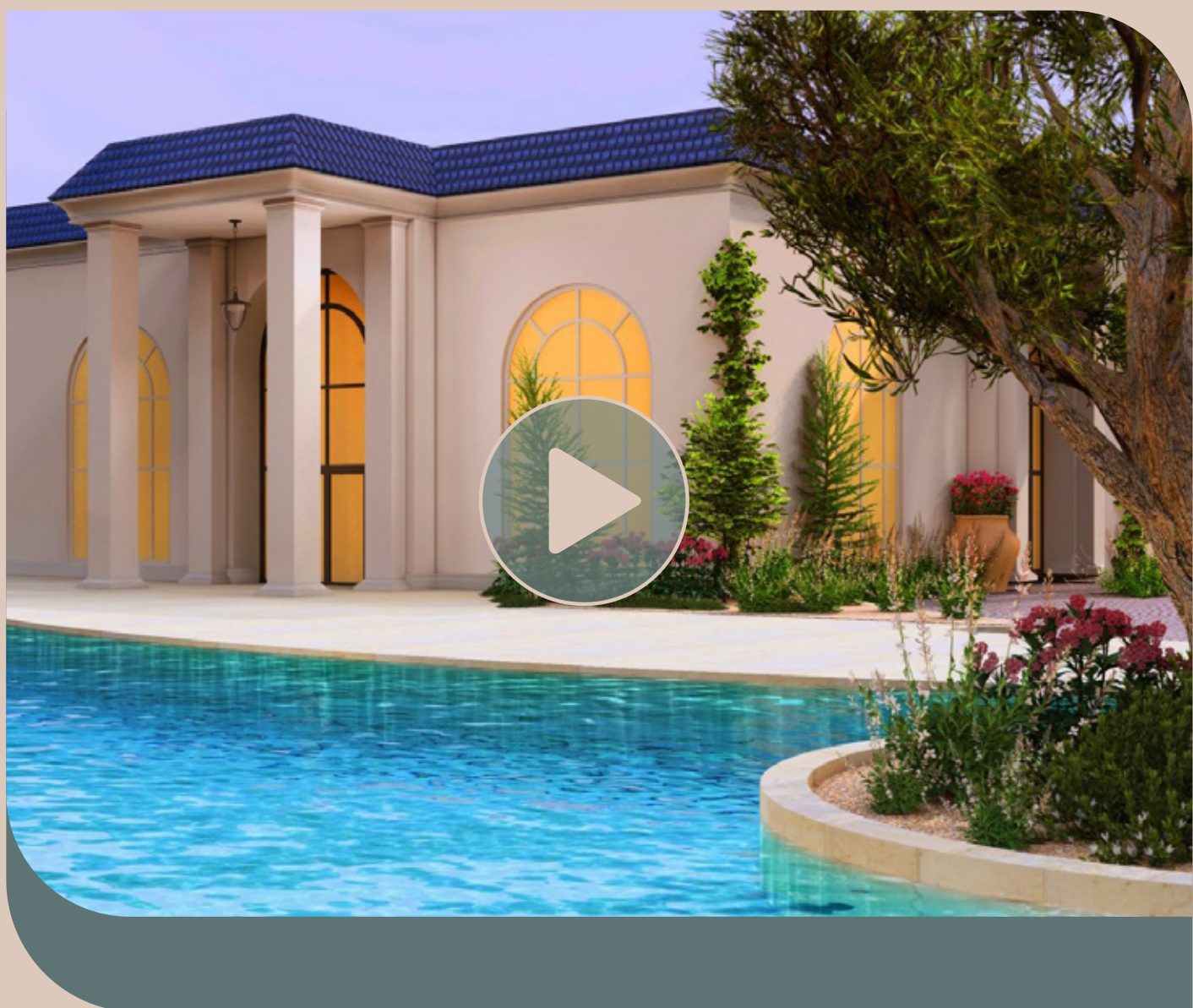

Thank You

CONNECT US

 9200 16874

 info@noxvenues.com

OR VISIT OUR WEBSITE



Disclaimer :

All images, designs, plans, information and data contained in this presentation have been prepared for illustrative and conceptual purposes only, and are considered preliminary and non-final. Accordingly, discrepancies or modifications may occur to measurements, dimensions, colors, materials, architectural details, or design or actual execution elements upon the execution stage and final development of the project, in accordance with operational, engineering and regulatory approved requirements.